

YARD LAYOUT

W.I.S.L. - WESTERN INDIA SHIPYARD LTD.

MORMUGAO PORT-GOIA

ANNEXURE I

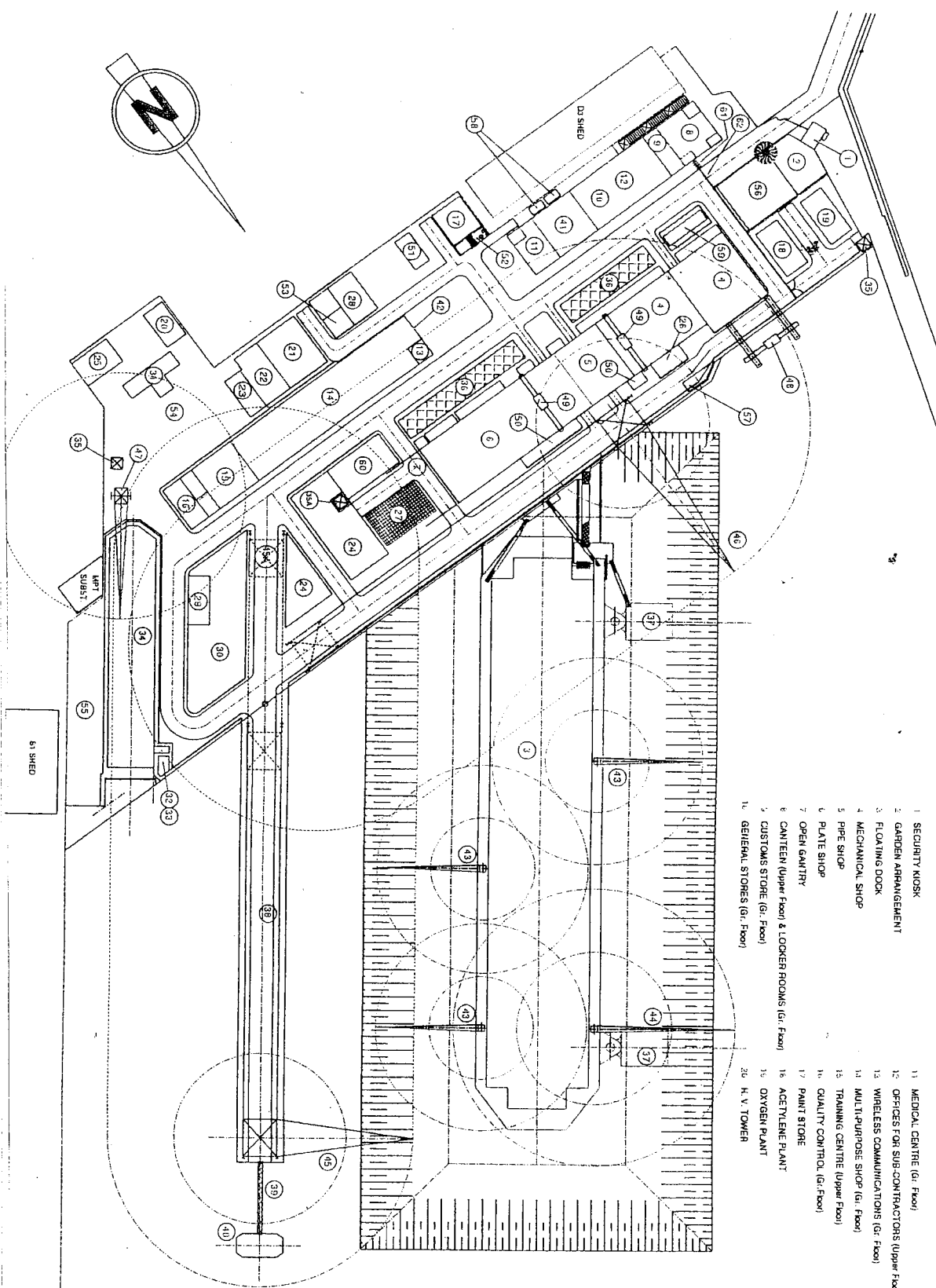

- 1 SECURITY KIOSK
- 2 GARDEN ARRANGEMENT
- 3 FLOATING DOCK
- 4 MECHANICAL SHOP
- 5 PIPE SHOP
- 6 PLATE SHOP
- 7 OPEN GANTRY
- 8 CANTEN (Upper Floor) & LOCKER ROOMS (Gr. Floor)
- 9 CUSTOMS STORE (Gr. Floor)
- 10 GENERAL STORES (Gr. Floor)
- 11 MEDICAL CENTRE (Gr. Floor)
- 12 OFFICES FOR SUB-CONTRACTORS (Upper Floor)
- 13 WIRELESS COMMUNICATIONS (Gr. Floor)
- 14 MULTI-PURPOSE SHOP (Gr. Floor)
- 15 TRAINING CENTRE (Upper Floor)
- 16 QUALITY CONTROL (Gr. Floor)
- 17 PAINT STORE
- 18 ACETYLENE PLANT
- 19 OXYGEN PLANT
- 20 H. V. TOWER
- 21 MAIN SUBSTATION (33 KV/3 KV)
- 22 EMERGENCY GENERATOR PLANT
- 23 AIR COMPRESSOR PLANT
- 24 STEEL YARD
- 25 WATER TANKS
- 26 WORKSHOPS & F.D.D. SUBSTATION (2 KV)
- 27 PRE-FABRICATION PLANE
- 28 SILOS FOR GRIT STORAGE (TEMPORARY)
- 29 GR. DRY DOCK & JETTY SUBSTATION (2.5KV)
- 30 SHIP SERVICE PARK
- 31 EFFLUENTS TREATMENT UNITS (TO BE RELOCATED)
- 32 GRAVING DRY DOCK PUMP HOUSE
- 33 FIRE WATER PUMP HOUSE
- 34 GRAVING DRY DOCK
- 35 LIGHTING TOWER (TO BE RELOCATED)
- 36 YARD PARKING SERVICE
- 37 F.L.D. MOORING OUT-PINS
- 38 WALKWAY
- 39 HELMAN JETTY
- 40 DOCKWAY
- 41 ADMINISTRATION & FINANCE OFFICES (Upper Floor)
- 42 TECHNICAL OFFICES (Upper Floor)
- 43 F.D.D. PEDESTAL CRANES (11 TON X 8 M)
- 44 F.D.D. PEDESTAL CRANE (20 TON X 27 M)
- 45 RAIL CRANE (50 TON X 30 M)
- 46 PROPOSED EXTENSION OF RAIL CRANE (50 TON RAIL CRANE (55 TON X 30 M))
- 47 45 TON MOBILE CRANE
- 48 25 TON EOT CRANE
- 49 10 TON EOT CRANES
- 50 COMPRESSOR STATION
- 51 WHEEL STORE
- 52 FIRE BRIGADE STATION
- 53 GRIT UNLOADING AREA (TEMPORARY)
- 54 SPACE NOT AVAILABLE (BEING USED BY BATCH PLANT TILL APRIL '96)
- 55 AREA TO BE ACQUIRED FROM LHPT TO INSTALL HANDLING AND SHIP SERVICE FACILITIES
- 56 CAR & SCOOTER PARK
- 57 PUMP HOUSE FOR F.D.D.
- 58 LUBRICANT STORE
- 59 WEIGH BRIDGE
- 60 SUB-ASSEMBLY STORAGE AREA
- 61 ENTRANCE/EXIT & TIME CONTROL FOR EMPLOYEE
- 62 LIFTING GATE FOR VEHICLES

LAND AREA: 31,000 SQ.MTS
 WATER AREA: 50,000 SQ.MTS

Power